

GROUP ASSEMBLY PARTS LIST

Figure and Index Number	SPCC-MFR Number	Hamilton Part Number	Part Name						Units Per Assy.
			1	2	3	4	5	6	
	F.S.S.C. 18-W-126	37625	Gimbal 35-Size Chronometer Watch Assembly						1
	F.S.S.C. 18-W-126	+37125	Gimbal 35-Size Chronometer Watch Assembly						Ref.
49-1	H18-HM-10043	+37152	Case - Carrying, gimbal watch, complete						Ref.
	H18-HM-10044	37622	Mounting Box and Gimbal Assembly						1
49-2	H18-HM-10045	37151	Box - Mounting, complete						1
	H18-HM-10046	37126A	Gimbal Assembly						1
49-3	H18-HM-10047	37134	Block - Front gimbal support						1
49-4	H18-HM-10022	42115	Screw - Front gimbal support block						2
49-5	H18-HM-10021	42123	Washer - Front gimbal support block screw						2
	H18-HM-10054	37137	Screw - Latch lever clamping						1
49-7	H18-HM-10061	37138	Washer - Latch lever clamping screw						1
49-8	H18-HM-10049	37135	Lever - Latch						1
49-9	H18-HM-10048	37136	Handle - Latch lever						1
49-10	H18-HM-10059	37143	Stud - Gimbal ring pivot						1
49-11	H18-HM-10053	37142	Screw - Gimbal ring rear pivot						1
49-12	H18-HM-10060	37145	Washer - Gimbal ring rear pivot screw						1
									(or more as req'd)
49-13	H18-HM-10050	37144	Nut - Pivot screw lock						1
49-14	H18-HM-10051	37131	Ring - Gimbal						1
49-15	H18-HM-10058	37132	Strap - Gimbal ring support						1
49-16	H18-HM-10052	37139	Screw - Gimbal ring support strap						2
49-16	H18-HM-10052	37139	Screw - Case support strap						2
49-17	H18-HM-10056	37141	Screw - Right case pivot						1
49-13	H18-HM-10050	37144	Nut - Right case pivot screw lock						1
49-18	H18-HM-10057	37133	Strap - Case support						1
49-19	H18-HM-10055	37140	Screw - Left case pivot						1
49-13	H18-HM-10050	37144	Nut - Left case pivot screw lock						1
49-20	H18-HM-10062	37623	Case and Movement Assembly - Gimbal chronometer watch						1
	H18-HM-10063	37621	Case - Complete with adjusting straps						1
49-21	H18-HM-10064	**37128	Bezel - Complete with crystal						1
49-22	H18-HM-10066	**37129	Bottom - Case						1
49-23	H18-HM-10065	**37127	Ring - Case						1
49-24	H18-HM-10067	37149	Crown						1
49-25	H18-HM-10084	37055	Stem - Winding						1
49-26	H18-HM-10069	37150	Plug - Dustproof stem seal						1
49-27	H18-HM-10072	37036	Sleeve - Stem						1
49-28	H18-HM-10074	37037	Spring - Stem sleeve						1
49-29	H18-HM-10070	37038	Ring - Stem sleeve spring seat						1
49-30	H18-HM-10071	37146	Screw - Safety setting push pin guide						1
49-31	H18-HM-10068	37147	Pin - Safety setting push						1
49-32	H18-HM-10073	37148	Spring - Safety setting push pin						1
49-33	H18-HM-10075	37130	Strap - Case adjusting						2
49-16	H18-HM-10052	37139	Screw - Case adjusting strap						4
49-34	H18-HM-10076	*37117	Watch Movement - Chronometer, 35-size, model 22						1

+Not currently supplied. Gimbal 35-Size Chronometer Watch Assembly No. 37125 which included Carrying Case No. 37152 is no longer furnished. For further information see Section I and Section II.

\*Not recommended for stocking.

\*\*Manufacturer recommends ordering case bottom, ring and bezel in matched sets.

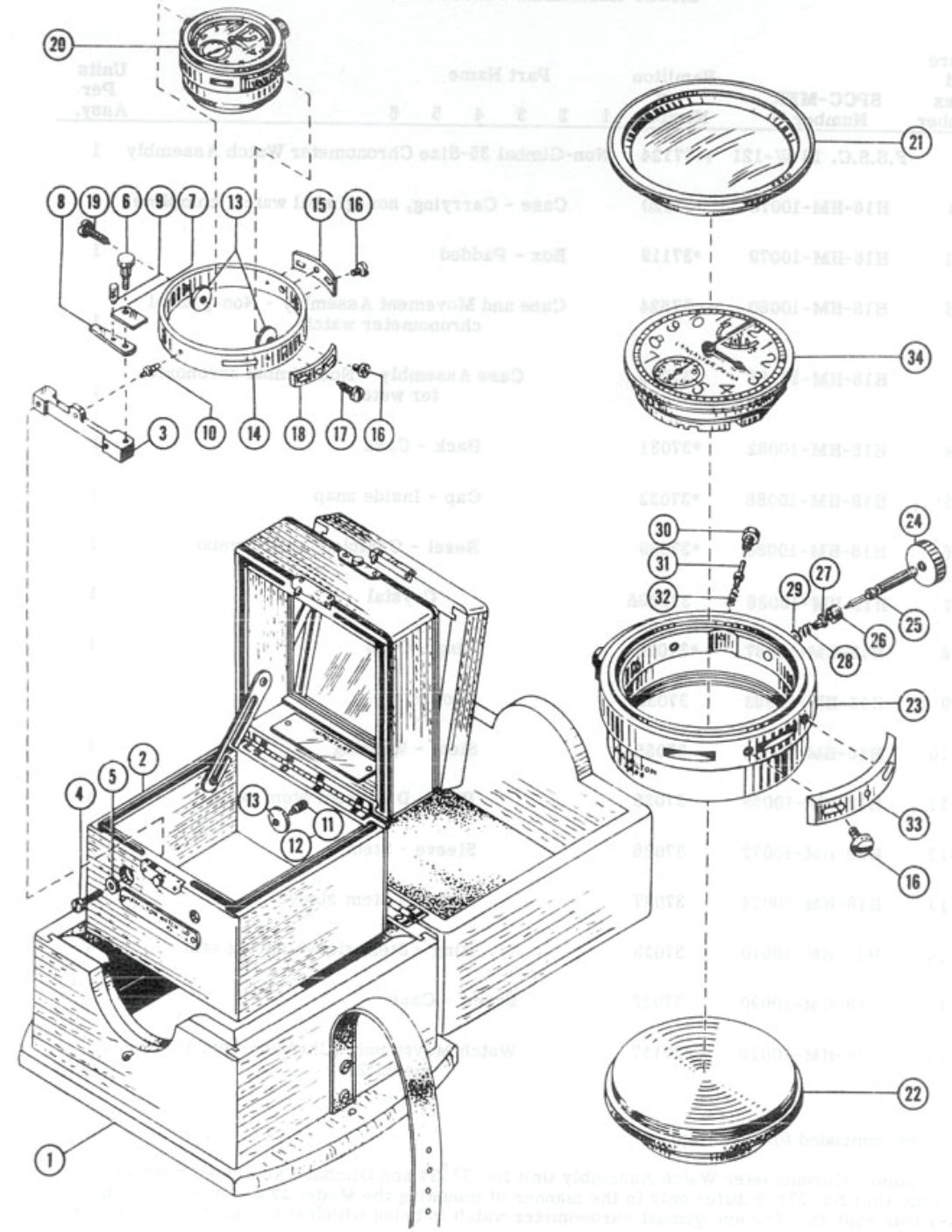

Figure 49