

HAMILTON 35-SIZE CHRONOMETER WATCH

GROUP ASSEMBLY PARTS LIST

Figure and Index Number	SPCC-MFR Number	Hamilton Part Number	Part Name							Units Per Assy.
			1	2	3	4	5	6	7	
	H18-HM-10076	37117	Watch Movement - Chronometer, 35-size, model 22 Ref.							
54-1	H18-HM-10172	37025	Bridge - Barrel, complete with steady pins							1
54-2	H18-HM-10109	42056	Screw - Bridge							3
54-3	H18-HM-10173	37075	Bushing - Differential upper							1
54-4	H18-HM-10174	37059	Wheel - Winding							1
54-5	H18-HM-10175	37067	Wheel - Ratchet							1
	H18-HM-10176	37084	Barrel Assembly - Complete with arbor and mainspring							1
	H18-HM-10177	*37086	Barrel - Sub-assembly							1
54-6	H18-HM-10178	*37086-1	Barrel							1
54-7	H18-HM-10165	*37087	Cap - Barrel							1
54-8	H18-HM-10179	37090	Mainspring - Complete with brace, standard strength - .195 mm. thick							1
	H18-HM-10410	37089	Mainspring - Complete with brace, .190 mm. thick							As Req'd.
	H18-HM-10560	37091	Mainspring - Complete with brace, .200 mm. thick							As Req'd.
54-9	H18-HM-10180	37085	Arbor - Barrel							1
54-10	H18-HM-10181	37073	Pinion - Alternating							1
54-11	H18-HM-10182	37072	Gear - Carrier, complete with planetary pinions							1
	H18-HM-10183	*37070	Pinion - Upper planetary							1
	H18-HM-10184	*37071	Pinion - Lower planetary							1
54-12	H18-HM-10185	37068	Gear - Wind-up, complete with pinion							1
	H18-HM-10186	*37109	Gear - Wind-up							1
	H18-HM-10187	*37069	Pinion - Differential sun							1
54-13	H18-HM-19188	37097	Click							1
54-14	H18-HM-10189	14766	Screw - Click							1
54-15	H18-HM-10190	37613	Guard - Click spring							1
54-16	H18-HM-10191	37098	Spring - Click							1
54-17	H18-HM-10193	37056	Pinion - Winding							1
54-18	H18-HM-10194	37057	Clutch							1
54-19	H18-HM-10212****	275	Jewel - Center lower bar-hole							1
54-20	H18-HM-10162****	37041	Setting - Third lower, complete with jewel							1
54-20	H18-HM-10162****	37041	Setting - Fourth lower, complete with jewel							1
54-21	H18-HM-10213****	33167	Setting - Escape lower, complete with jewel							1
54-21	H18-HM-10213****	33167	Setting - Pallet lower, complete with jewel							1
54-21	H18-HM-10213****	33167	Setting - Balance lower, complete with jewel							1

\*Not recommended for stocking.

\*\*\*\*Jewels are ordinarily removed after pillar plate parts have been completely disassembled. They are listed here for purposes of illustration.

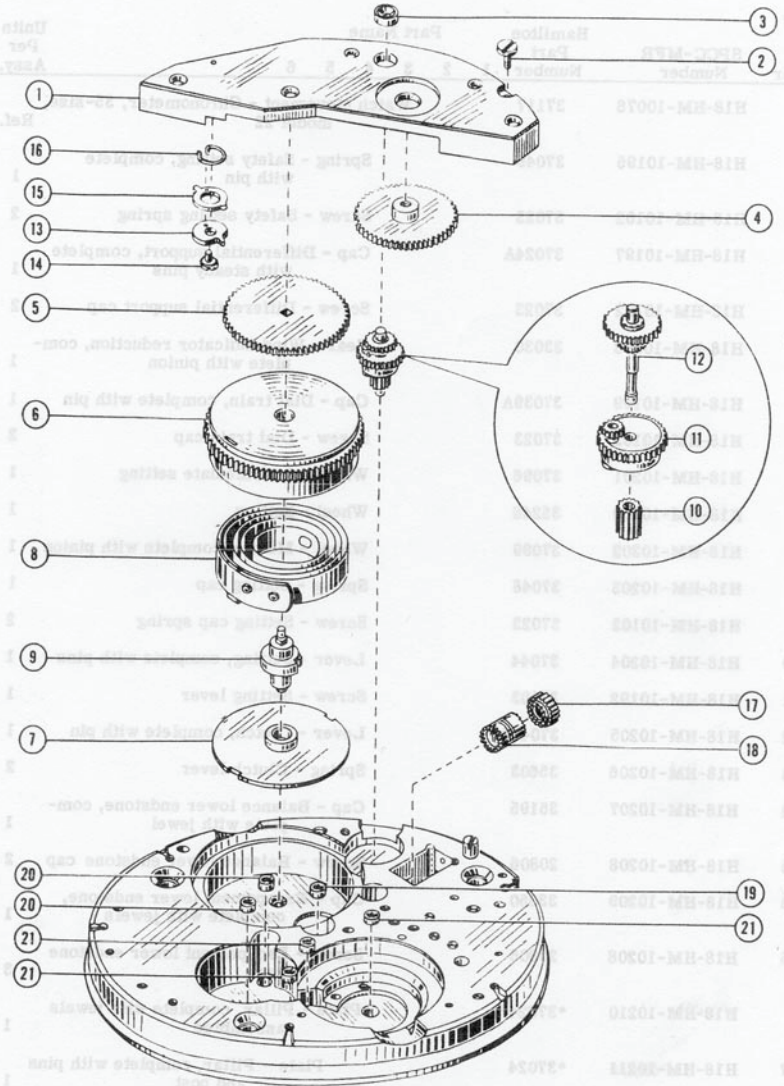

Figure 54