

GROUP ASSEMBLY PARTS LIST

| Figure and Index Number | SPCC-MFR Number | Hamilton Part Number | Part Name | | | | | | Units Per Assy. |
|-------------------------|-----------------|----------------------|---|---|---|---|---|---|-----------------|
| | | | 1 | 2 | 3 | 4 | 5 | 6 | |
| | H18-HM-10076 | 37117 | Watch Movement - Chronometer, 35-size, model 22 | | | | | | Ref. |
| 55-1 | H18-HM-10195 | 37049 | Spring - Safety setting, complete with pin | | | | | | 1 |
| 55-2 | H18-HM-10102 | 37023 | Screw - Safety setting spring | | | | | | 2 |
| 55-3 | H18-HM-10197 | 37024A | Cap - Differential support, complete with steady pins | | | | | | 1 |
| 55-2 | H18-HM-10102 | 37023 | Screw - Differential support cap | | | | | | 2 |
| 55-4 | H18-HM-10198 | 33030 | Gear - Wind indicator reduction, complete with pinion | | | | | | 1 |
| 55-5 | H18-HM-10199 | 37039A | Cap - Dial train, complete with pin | | | | | | 1 |
| 55-2 | H18-HM-10102 | 37023 | Screw - Dial train cap | | | | | | 2 |
| 55-6 | H18-HM-10201 | 37096 | Wheel - Intermediate setting | | | | | | 1 |
| 55-7 | H18-HM-10200 | 35246 | Wheel - Setting | | | | | | 1 |
| 55-8 | H18-HM-10202 | 37099 | Wheel - Minute, complete with pinion | | | | | | 1 |
| 55-9 | H18-HM-10203 | 37048 | Spring - Setting cap | | | | | | 1 |
| 55-2 | H18-HM-10102 | 37023 | Screw - Setting cap spring | | | | | | 2 |
| 55-10 | H18-HM-10204 | 37044 | Lever - Setting, complete with pins | | | | | | 1 |
| 55-11 | H18-HM-10192 | 37103 | Screw - Setting lever | | | | | | 1 |
| 55-12 | H18-HM-10205 | 37047A | Lever - Clutch, complete with pin | | | | | | 1 |
| 55-13 | H18-HM-10206 | 35603 | Spring - Clutch lever | | | | | | 2 |
| 55-14 | H18-HM-10207 | 35195 | Cap - Balance lower endstone, complete with jewel | | | | | | 1 |
| 55-15 | H18-HM-10208 | 20806 | Screw - Balance lower endstone cap | | | | | | 2 |
| 55-16 | H18-HM-10209 | 33050 | Cap - Escapement lower endstone, complete with jewels | | | | | | 1 |
| 55-15 | H18-HM-10208 | 20806 | Screw - Escapement lower endstone cap | | | | | | 3 |
| | H18-HM-10210 | *37024A | Plate - Pillar, complete with jewels assembled | | | | | | 1 |
| 55-17 | H18-HM-10211 | *37024 | Plate - Pillar, complete with pins and post | | | | | | 1 |

*Not recommended for stocking.

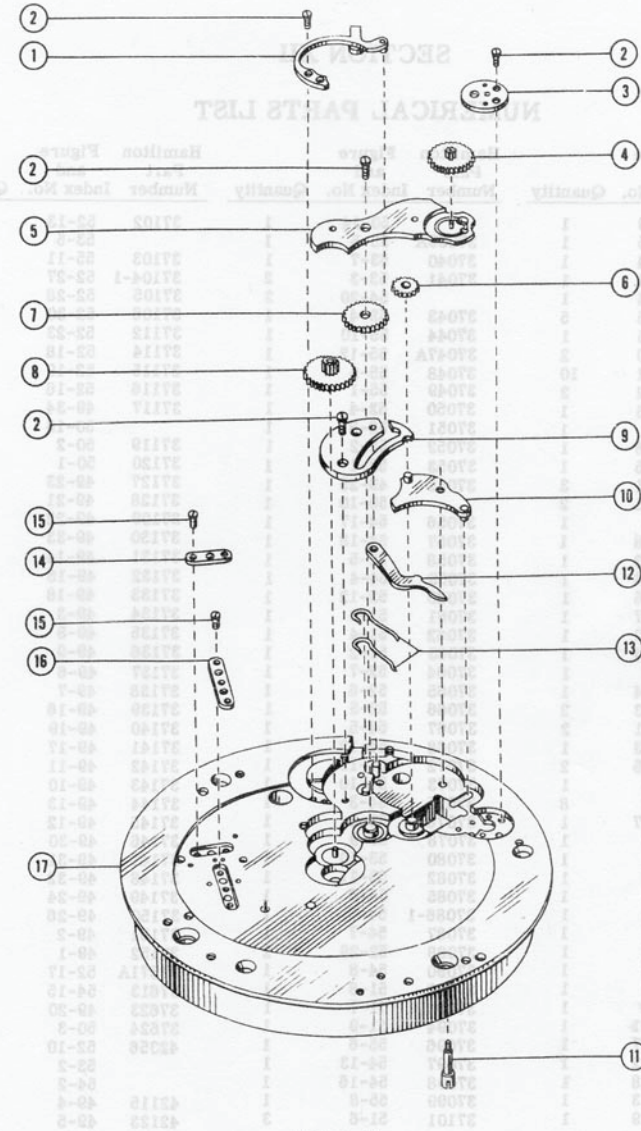

Figure 55